



Contact: Kimberly Gallegos – (505) 639-3576  
[Kimberly.Gallegos@state.nm.us](mailto:Kimberly.Gallegos@state.nm.us)

**Southbound I-25 Traffic to Shift to New Lanes and Two Ramps To Be Closed at I-25 and Rio Bravo Beginning Friday, May 18**

**ALBUQUERQUE, 5-16-18**—Construction on the I-25 Rio Bravo Project will move completely in Phase 2 beginning Friday morning, May 18. Southbound I-25 traffic will be shifted to the new permanent lanes just west of the existing northbound lanes and north of the Rio Bravo interchange. Also, the I-25 southbound on-ramp will be closed at Rio Bravo through fall 2018, and the I-25 northbound off-ramp will be closed at Rio Bravo through spring 2019. Motorists will be able to use Broadway Boulevard as a detour (*see map*).

The ramp closures will allow crews to begin working on a new bridge at the interchange, improve both closed ramps and expand lanes on I-25.

Phase 2 construction is expected to last through fall 2018, and the entire project is expected to be completed in summer 2019.

Project official encouraged motorists to use extra caution for the new few days in the construction area and on Broadway Boulevard as they get used to the new lanes and the detour.

Speed limits are reduced in the construction zone. Drivers should follow all construction signage carefully and give themselves extra time to reach their destinations.

More information is available at [www.i25riobravo.com](http://www.i25riobravo.com) or [www.nmroads.com](http://www.nmroads.com).

All construction is weather permitting and subject to change without notice

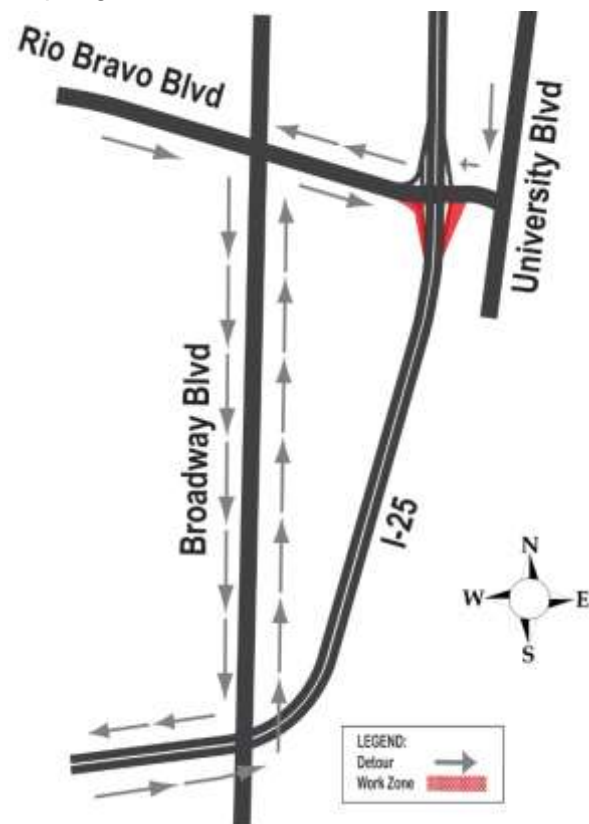

###