



## Construction Update: Oct. 8-14, 2018

*NOTE: All work is scheduled weather permitting and is subject to change without notice.*

Regular construction hours are **Monday-Saturday 7 a.m.-5 p.m.** although crews may work Sundays and/or evenings if needed.

**Northbound I-25** – Traffic remains shifted to the right lane and shoulder through most of the construction zone; northbound I-25 is reduced to two lanes just south of the I-25 northbound on-ramp. The I-25 northbound off-ramp is **closed** at Rio Bravo through spring 2019. Broadway is the detour (see map).

**Southbound I-25** – Traffic has been shifted to new permanent lanes just west of the existing northbound lanes and north of the Rio Bravo interchange. The I-25 southbound on-ramp is **closed** at Rio Bravo through fall 2018. Broadway is the detour (see map).

**Eastbound Rio Bravo** – Has a dedicated left turn lane for eastbound traffic to turn north on Broadway.

**Westbound Rio Bravo** – Has a dedicated left turn lane for westbound traffic to turn south on Broadway.

**NOTE:** *There are traffic restrictions and lane reductions on northbound and southbound Broadway near the Rio Bravo interchange. Also, there may be various lane closures during the evening on I-25 as needed.*

**Electric Avenue** – There is no access to Electric Avenue from southbound Broadway.

### **SPEED LIMITS ARE REDUCED IN THE CONSTRUCTION ZONE.**

**NOTE:** The multi-use path is closed about 400 feet west of the intersection of Broadway and Rio Bravo for safety for the duration of the project.

*Motorists should expect delays, particularly during morning and afternoon commutes or nighttime work, obey reduced speeds in the construction zone and watch for construction signs.*

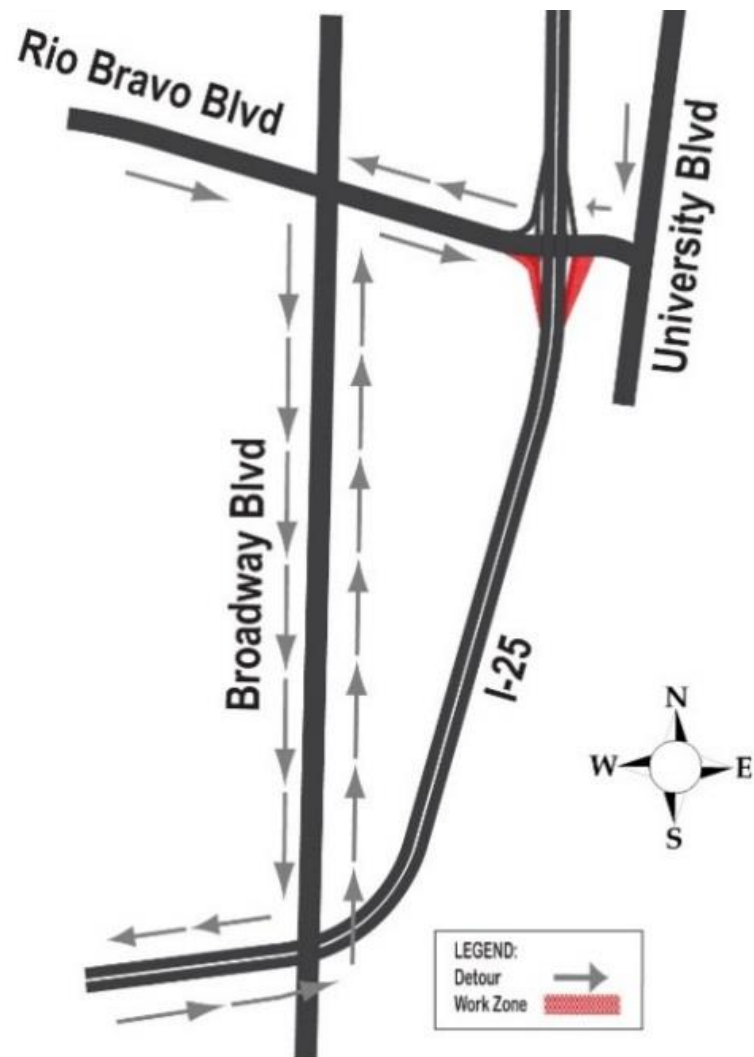

For More Information: **Contact Patti Watson - 245-3134, 269-9691** or [pattiw@cwastrategic.com](mailto:pattiw@cwastrategic.com). You can also sign up for notifications at [www.nmroads.com](http://www.nmroads.com).