



Construction Update: Oct. 1-7, 2018

NOTE: All work is scheduled weather permitting and is subject to change without notice.

Regular construction hours are **Monday-Saturday 7 a.m.-5 p.m.** although crews may work Sundays and/or evenings if needed.

TENTATIVE: On **Tuesday, Oct. 2** and **Wednesday, Oct. 3**, the **southbound I-25 off-ramp at Rio Bravo will be closed** from **8 p.m. each evening to 5 a.m. the next morning**. **Southbound I-25 motorists can exit I-25 at Gibson or Broadway.**

Northbound I-25 – Traffic remains shifted to the right lane and shoulder through most of the construction zone; northbound I-25 is reduced to two lanes just south of the I-25 northbound on-ramp. The I-25 northbound off-ramp is **closed** at Rio Bravo through spring 2019. Broadway is the detour (*see map*).

Southbound I-25 – Traffic has been shifted to new permanent lanes just west of the existing northbound lanes and north of the Rio Bravo interchange. The I-25 southbound on-ramp is **closed** at Rio Bravo through fall 2018. Broadway is the detour (*see map*).

Eastbound Rio Bravo – Has a dedicated left turn lane for eastbound traffic to turn north on Broadway.

Westbound Rio Bravo – Has a dedicated left turn lane for westbound traffic to turn south on Broadway.

NOTE: *There are traffic restrictions and lane reductions on northbound and southbound Broadway near the Rio Bravo interchange. Also, there may be various lane closures during the evening on I-25 as needed.*

Electric Avenue – There is no access to Electric Avenue from southbound Broadway.

SPEED LIMITS ARE REDUCED IN THE CONSTRUCTION ZONE.

NOTE: The multi-use path is closed about 400 feet west of the intersection of Broadway and Rio Bravo for safety for the duration of the project.

Motorists should expect delays, particularly during morning and afternoon commutes or nighttime work, obey reduced speeds in the construction zone and watch for construction signs.

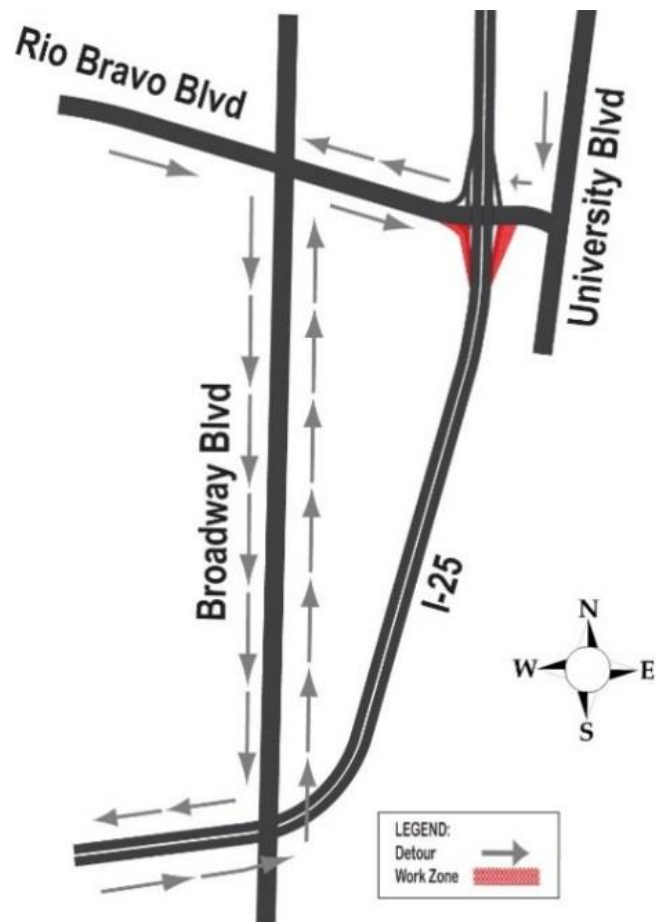

For More Information: **Contact Patti Watson - 245-3134, 269-9691** or pattiw@cwastrategic.com. You can also sign up for notifications at www.nmroads.com.