

Construction Update: January 28-February 3, 2019



NOTE: All work is scheduled weather permitting and is subject to change without notice.

Regular construction hours are **Monday-Saturday 7 a.m.-5 p.m.** although crews may work Sundays and/or evenings if needed.

NORTHBOUND I-25 On-Ramp to Shift: The northbound I-25 on-ramp will shift as of **Saturday, February 1, 2019**. There will continue to be two lanes to access the ramp, which will then quickly merge into one lane approaching northbound I-25.

Northbound I-25 – Traffic on northbound (NB) I-25 has shifted to the left (west), with two (2) lanes open through the interchange. The NB on-ramp is no longer be a merge lane. Instead, it will continue as a third lane. The NB off-ramp will remain closed through spring 2019 (see map).

Southbound I-25 – Traffic is on a **new alignment at the I-25/Rio Bravo exit**. The I-25 southbound on-ramp is **closed** to westbound traffic through winter 2018 but is now open to eastbound traffic on Rio Bravo (see map).

Eastbound Rio Bravo – Traffic is shifted to the right in newly constructed lanes. Approaching the intersection of Rio Bravo and Broadway, there are two (2) lanes of traffic open. Once traffic is east of that intersection, there are three (3) lanes open. **The right lane will be to access the I-25 southbound (SB) on-ramp ONLY** (see map).

Westbound Rio Bravo -- Has a dedicated left turn lane for westbound traffic to turn south on Broadway.

Broadway near Rio Bravo -- All new lanes for northbound and southbound Broadway are open.

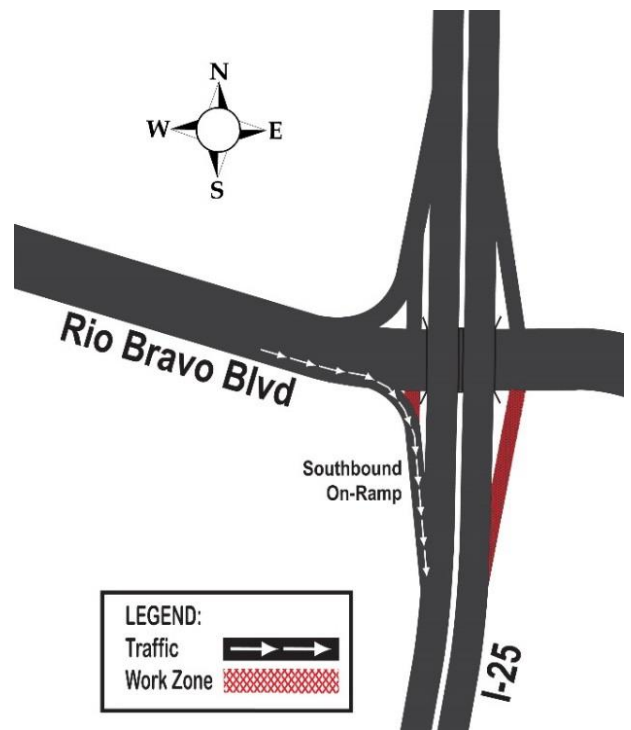

SPEED LIMITS ARE REDUCED IN THE CONSTRUCTION ZONE.

NOTES: The multi-use path is closed about 400 feet west of the intersection of Broadway and Rio Bravo for safety for the duration of the project.

Wagner Road is also closed to through traffic.

Also, there is no access to Electric Avenue from southbound Broadway.

Motorists should expect delays, particularly during morning and afternoon commutes or nighttime work, obey reduced speeds in the construction zone and watch for construction signs.

For More Information: **Contact Patti Watson - 245-3134, 269-9691** or pattiw@cwastrategic.com. You can also sign up for notifications at www.nmroads.com.